

Saumarez Cottage Floor Plan & Emergency Information

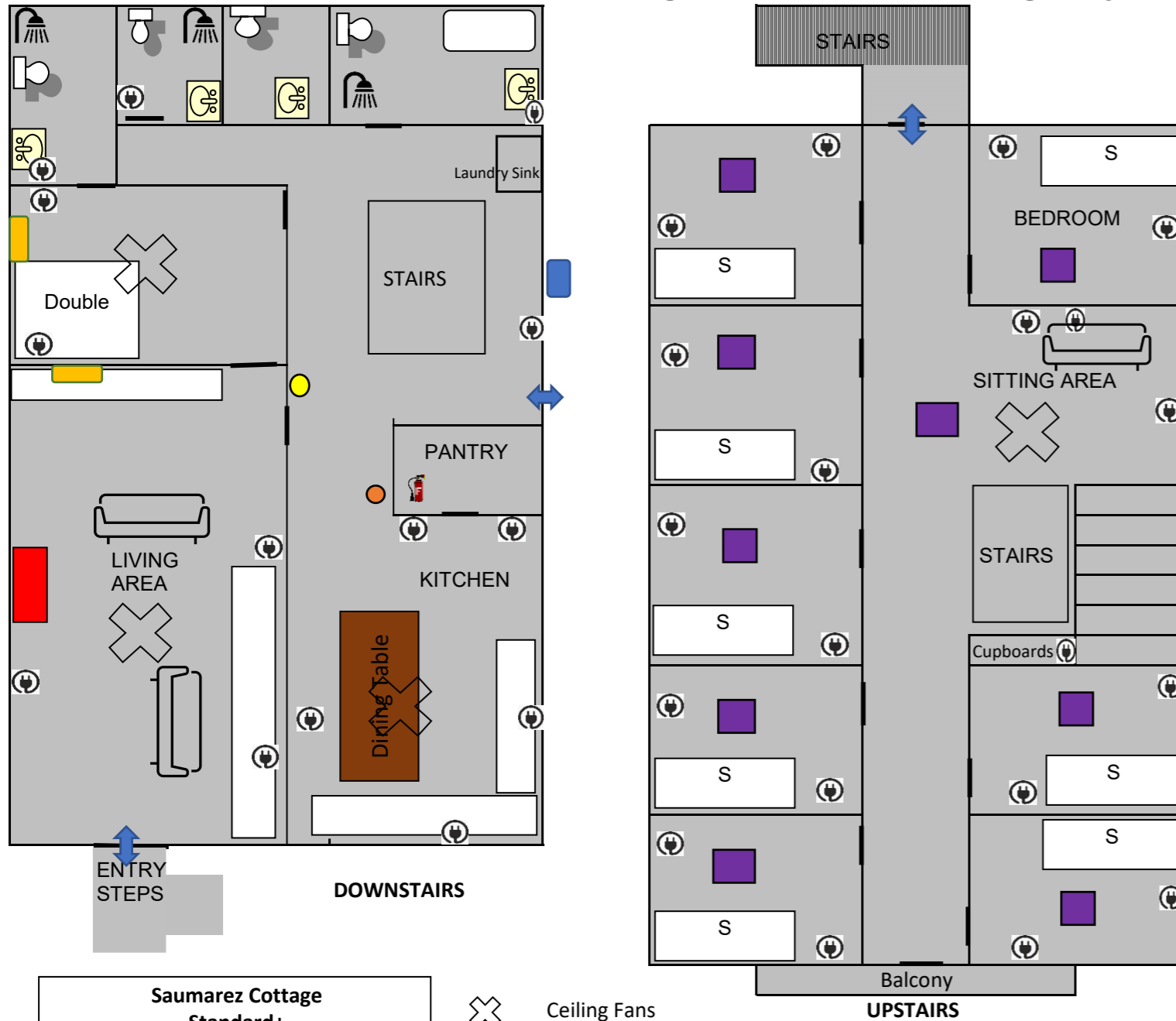

Saumarez Cottage Standard+
Sleeps 10

- 9 Bedroom
- 1 Double
- 8 Singles (S)
- 3 Bathrooms
- 4 Toilets
- Wood Fireplace
- Reverse Cycle Airconditioning

- Ceiling Fans
- Entrances & Exits
- Fire Blanket
- Fire Extinguisher
- Fire Place
- Gas Cut off Point
- Hot Water System
- Power Points
- Reverse Cycle Airconditioning
- Switch Board
- Water Mains
- Evaporative Cooling

Reception Open
0830-1630
Closed at weekends
& Public Holidays

Caretakers - 0419 919 028
Emergency Only - Call out fees may apply



- Notes:**
- The Fire Pit is only for guests and is not available during summer and fire season.
 - Toilets near Cricket Nets are only for school camps and community functions.
 - The swimming pool is open for guests only.
 - Bike Shed is open for school camps only.

If you discover a fire:

- Warn others in the immediate vicinity that a fire exists.
- If unable to extinguish the fire immediately evacuate the area, by following the emergency exit signs and proceed to the Assembly point at the Oval (see map).
- Inform the reception staff (9531 1177) ext 100 during office hours, or the Caretaker (0419 919 028) outside office hours, that a fire exists.
- If you are trained and confident that you are not placing yourself at risk of injury, attempt to extinguish the fire using appropriate fire extinguisher.
- If you are responsible for a visitor or contractor, you should ensure these persons follow the correct evacuation procedure.
- You should render assistance to injured personnel if capable but do not put yourself at risk.